

ENGINE-Cylinder Head

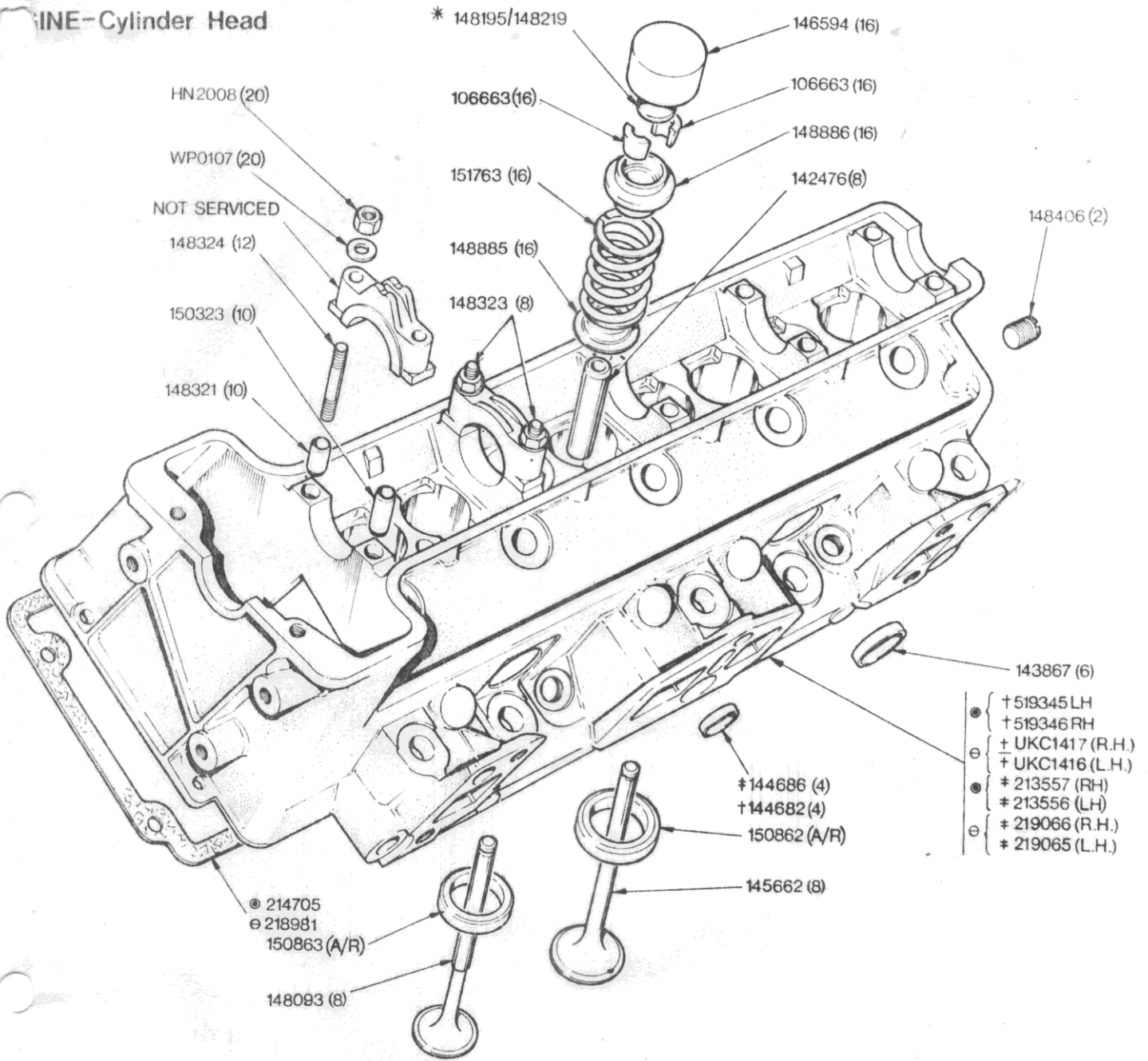

NOTE

† Complete with Valves, Springs and Camshaft

‡ Less Valves, Springs and Camshaft

144254 LOCTITE, STUDLOC

148195 PALLET, ADJUSTING TAPPET .090"

148196 " " " .091"

148197 " " " .092"

148198 " " " .093"

148199 " " " .094"

148200 " " " .095"

148201 " " " .096"

148202 " " " .097"

148203 " " " .098"

148204 " " " .099"

148205 " " " .100"

148206 PALLET, ADJUSTING TAPPET .101"

148207 " " " .102"

148208 " " " .103"

148209 " " " .104"

148210 " " " .105"

148211 " " " .106"

148212 " " " .107"

148213 " " " .108"

148214 " " " .109"

148215 " " " .110"

148216 " " " .111"

148217 " " " .112"

148218 " " " .113"

148219 " " " .114"

● Fitted up to Engine Number LE20,000UE only

⊖ Fitted from Engine Number LE20,001UE and future

ENGINE

02-06 Cylinder Head	Part No	
	Triumph	Rimmer Bros
Split collets	106663	106663
Valve guide	142476	142476
Core plug - 1.125"	143867	143867
Core plug - 1.250"	144686	144686
Inlet valve	145662	145662
Cam follower - standard	146594	146594
Exhaust valve	148093	155524
Pallet, adjusting tappet - 0.090"	148195	148195
Pallet, adjusting tappet - 0.091"	148196	148196
Pallet, adjusting tappet - 0.092"	148197	148197
Pallet, adjusting tappet - 0.093"	148198	148198
Pallet, adjusting tappet - 0.094"	148199	148199
Pallet, adjusting tappet - 0.095"	148200	148200
Pallet, adjusting tappet - 0.096"	148201	148201
Pallet, adjusting tappet - 0.097"	148202	148202
Pallet, adjusting tappet - 0.098"	148203	148203
Pallet, adjusting tappet - 0.099"	148204	148204
Pallet, adjusting tappet - 0.100"	148205	148205
Pallet, adjusting tappet - 0.101"	148206	148206
Pallet, adjusting tappet - 0.102"	148207	148207
Pallet, adjusting tappet - 0.103"	148208	148208
Pallet, adjusting tappet - 0.104"	148209	148209
Pallet, adjusting tappet - 0.105"	148210	148210
Pallet, adjusting tappet - 0.106"	148211	148211
Pallet, adjusting tappet - 0.107"	148212	148212
Pallet, adjusting tappet - 0.108"	148213	148213
Pallet, adjusting tappet - 0.109"	148214	148214
Pallet, adjusting tappet - 0.110"	148215	148215
Pallet, adjusting tappet - 0.112"	148217	148217
Pallet, adjusting tappet - 0.113"	148218	148218
Pallet, adjusting tappet - 0.114"	148219	148219
Dowel	148321	148321
Stud	148323	
Stud	148324	148324
Plug (rear of heads)	148406	UKC3163
Valve spring collar - lower	148885	148885
Valve spring collar - upper	148886	148886
Dowel	150323	150323
Valve seat - inlet	150862	150862
Valve seat - exhaust	150863	150863
Valve spring	151763	151763
Cylinder head assembly - LH to engine no LE20001UE *	213556	
Cylinder head assembly - RH to engine no LE20001UE *	213557	
Cylinder head gasket - to engine no LE20000UE	214705	GEG1223
Cylinder head gasket - from engine no LE20001UE	218981	
Cylinder head assembly - LH from engine no LE20001UE *	219065	
Cylinder head assembly - RH from engine no LE20001UE *	219066	
Cylinder head assembly - LH to engine no LE20001UE *	519345	
Cylinder head assembly - RH to engine no LE20001UE *	519346	

ENGINE

02-06 Cylinder Head continued	Part No	
	Triumph	Rimmer Bros
Nut	HN2008	GHF201
Cylinder head assembly - LH from engine no LE20001UE *	UKC1416	RS1016
Cylinder head assembly - RH from LE20001UE *	UKC1417	RS1017
Washer - plain	WP0107	GHF332
Pallet, adjusting tappet - 0.115"		UKC1985
Pallet, adjusting tappet - 0.116"		UKC1986
Pallet, adjusting tappet - 0.117"		UKC1987
Pallet, adjusting tappet - 0.118"		UKC1988
Pallet, adjusting tappet - 0.119"		UKC1989
Pallet, adjusting tappet - 0.120"		UKC1990
Pallet, adjusting tappet - 0.121"		UKC1991
Pallet, adjusting tappet - 0.122"		UKC1992
Pallet, adjusting tappet - 0.123"		UKC1993
Pallet, adjusting tappet - 0.124"		UKC1994
Pallet, adjusting tappet - 0.125"		UKC1995
Pallet, adjusting tappet - 0.126"		UKC1996
Pallet, adjusting tappet - 0.127"		UKC1997
Pallet, adjusting tappet - 0.128"		UKC1998
Pallet, adjusting tappet - 0.129"		UKC1999
Pallet, adjusting tappet - 0.130"		UKC2000
Cam follower - 0.010"		146594.1

* Complete with valves, springs and camshaft