

# LINE - Camshaft, Rocker Cover and Head Attachment Details

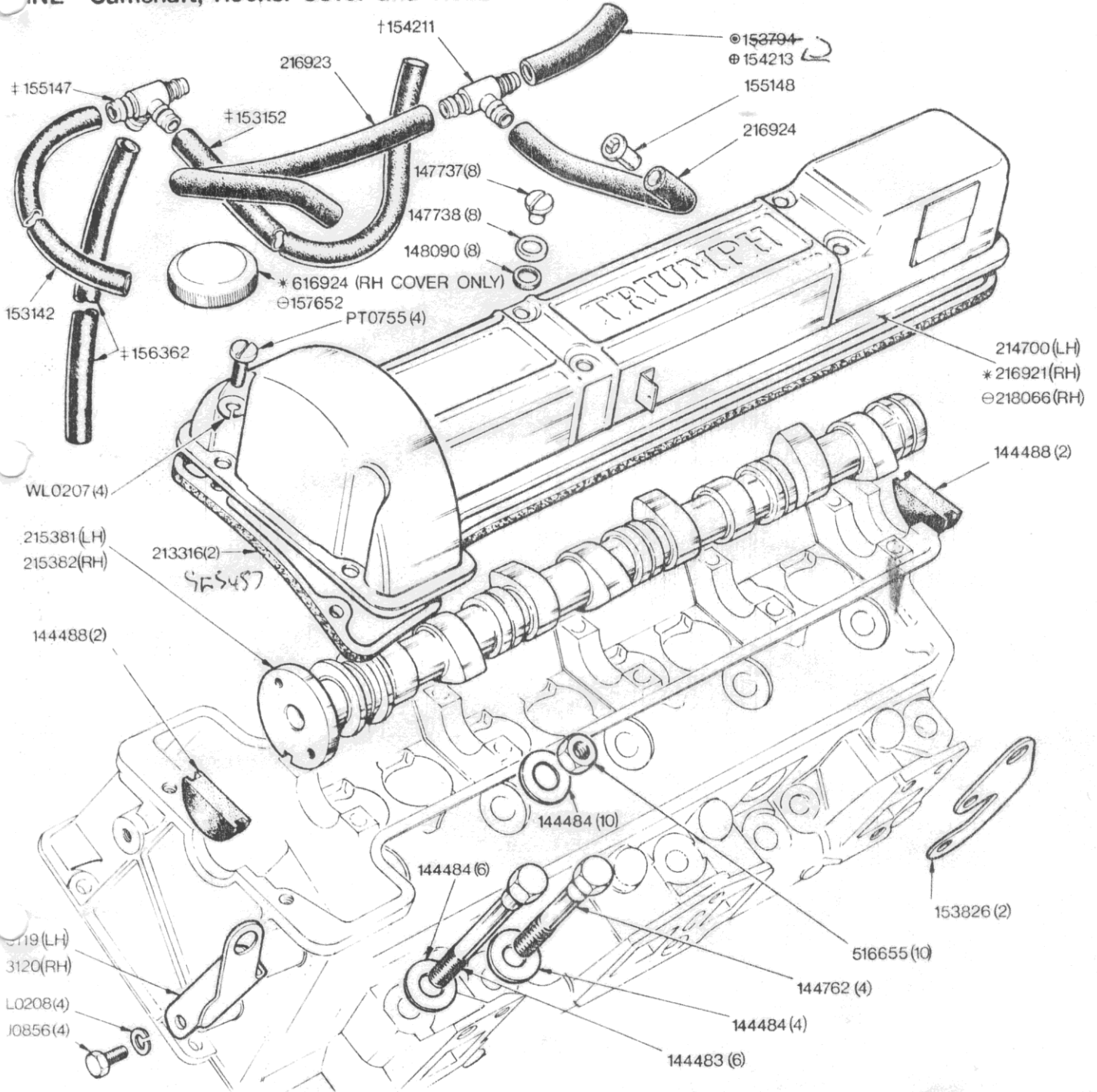

† Only required for Anti-pollution Engines  
 † Not required for Anti-pollution Engines  
 † 157652 Filler Cap to be used with Cover 218066  
 † as marked thus \* are fitted up to Commission No.LF10,000 only  
 † as marked thus † are fitted from Commission No.LF10,001 and future  
 † fitted up to Engine No. only  
 † fitted from Engine No. and future

# ENGINE

02-07 Camshaft, Rocker Cover & Head Attachment Details	Part No	
	Triumph	Rimmer Bros
Bolt	144483	UKC9871
Washer	144484	UKC9786
U-end plug	144488	144488
Bolt	144762	144762
Screw - camshaft cover to head	147737	147737
Cup washer	147738	147738
Sealing ring	148090	148090
Lifting eye - front LH	153119	153119
Lifting eye - front RH	153120	153120
Hose, only required for anti-pollution engines	153152	
Hose, only required for anti-pollution engines	153412	
Breather hose, to engine number	153794	
Lifting eye - rear	153826	153826
T-piece, not required for anti-pollution engines	154211	154211
Breather hose, from engine number	154213	154213
4-way adaptor, only required for anti-pollution engines	155147	
Carburettor adaptor	155148	154934
Hose - 4-way connector to canister, only required for anti-pollution engines	156362	
Oil filler cap - from LF10001 (2 prong)	157652	GFE6015
Camshaft cover gasket	213316	GEG457
Camshaft cover - LH	214700	214700
Camshaft - LH	215381	215381
Camshaft - RH	215382	215382
Camshaft cover - RH to LF10000	216921	
RH Carburettor breather pipe	216923	216923
LH Carburettor breather pipe	216924	216924
Camshaft cover - RH from LF10000	218066	216921
Nut - head to block studs	516655	UKC9954
Oil filler cap - to LF10000 (3 prong)	616924	601761
Setscrew	HU0856	SH505061
Screw - camshaft cover end	PT0755	SE504051
Washer - camshaft cover end	WL0207	GHF331
Washer - lock	WL0208	GHF332