

ENGINE--Crankshaft, Flywheel, Piston, Conn.Rod and Idler Shaft.

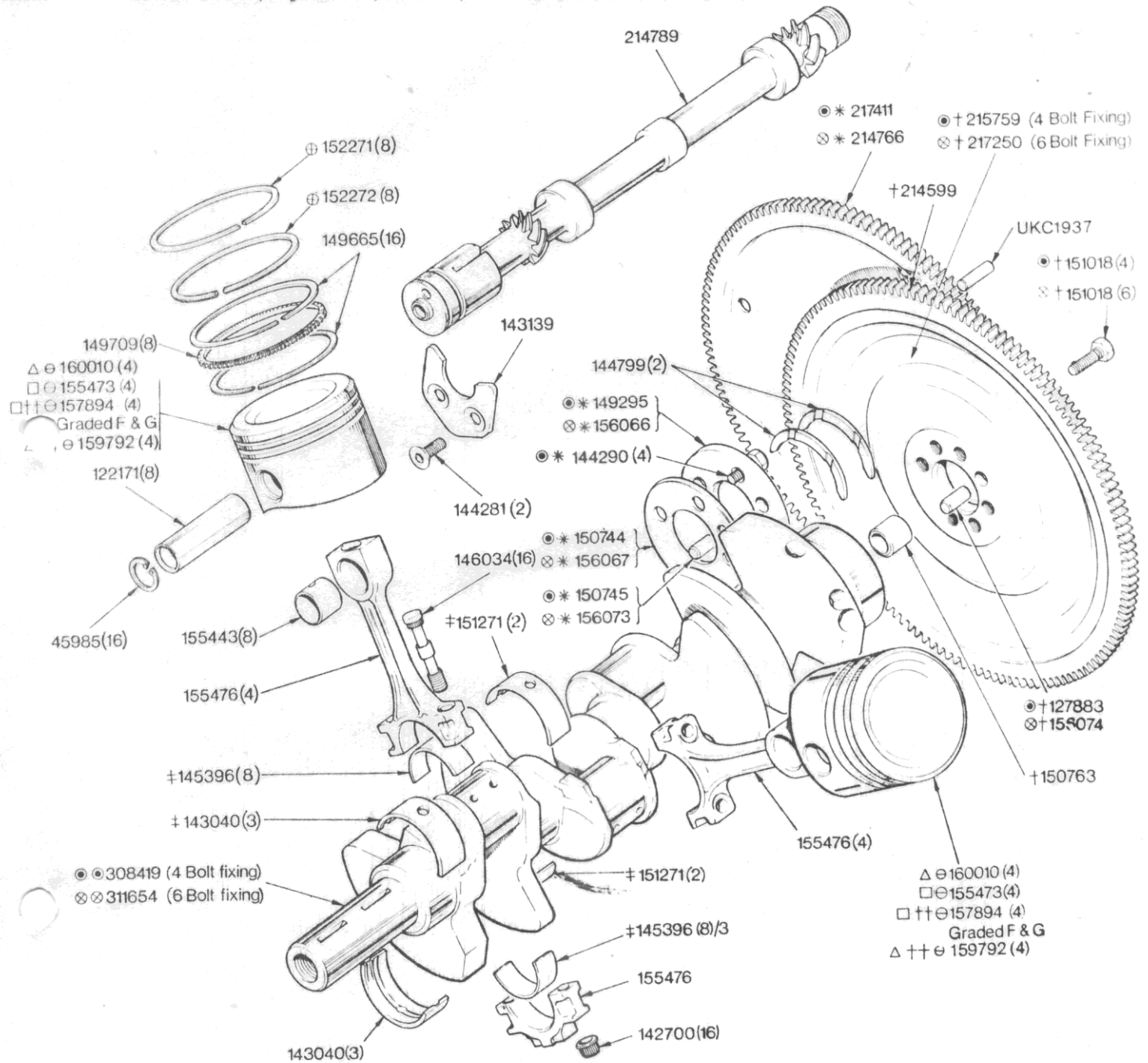

NOTE

- * Items marked thus are fitted with automatic transmission only
- † Items marked thus are not required when automatic transmission is fitted
- Items marked thus are fitted up to Engine no.LF273E only
- ⊗ Items marked thus are fitted from Engine no.LF274 E and future
- ‡ Main Bearings and Big End Bearings are obtainable in the following undersizes:---010"-020"-030"
- ⊖ Piston assemblies are obtainable in +.020" oversize
- ⊕ Piston Rings are obtainable in the following oversizes:-+.010"+.020"+.030"
- Items marked thus are fitted up to engine No LF 509E only.
- ⊗⊗ Items marked thus are fitted up to engine No LF 510E and future.
- †† Anti-Pollution USA only. Fitted from Engine No LE10,001 E and future
- 144799 Thrust Washer SO5 O/G 2 off

- Fitted up to Engine No. LF20,000E only
- △ Fitted from Engine No. 20,001E and future

when ordering please
quote undersize or
oversize requirements
e.g. 145396/ .020

ENGINE

02-10 Crankshaft, Flywheel, Piston, Connecting Rod & Idler Shaft	Part No	
	Triumph	Rimmer Bros
Circlip	45985	45985
Gudgeon pin	122171	122171
Dowel - manual transmission only, to engine no LF273E	127883	
Connecting rod bolt nut	142700	142700
Main front bearing	143040	
Bolt - automatic transmission only, to engine no LF273E	144290	
Bolt - automatic transmission only, from engine no LF274E	144290	
Thrust washer	144799	RTC2836
Connecting rod bearing	145396	
Connecting rod bolt	146034	146034
Distance piece - automatic transmission only, to engine no LF273E	149295	
Chrome rail	149665	
Spacer	149709	
Driving plate washer - automatic transmission only, to engine no LF273E	150744	
Dowel - automatic transmission only, to engine no LF273E	150745	
Pilot/Spigot bush - manual transmission only	150763	150763
Bolt - manual transmission only	151018	UKC3044
Bolt - automatic transmission only, to engine no LF273E	151018	
Bolt - automatic transmission only, from engine no LF274E	151018	UKC3044
Main intermediate bearing	151271	
Compression ring	152271	
Compression ring	152272	
Small end bush	155443	155443
Connecting rod assembly	155476	155476
Distance piece - automatic transmission only, from engine no LF274E	156066	156066
Driving plate washer - automatic transmission only, from engine no LF274E	156067	156067
Dowel - automatic transmission only, from engine no LF274E	156073	156073
Dowel - manual transmission only, from engine no LF274E	156074	156074
Starter ring - manual transmission only	214599	214599
Drive plate - automatic transmission only, from engine no LF274E	214766	214766
Flywheel assembly - 4 bolt fixing, manual transmission only, to LF273E	215759	
Flywheel assembly - 6 bolt fixing, manual transmission only, from LF274E	217250	217250
Drive plate - automatic transmission only, to engine no LF273E	217411	
Crankshaft - 4 bolt fixing, to engine no LF509E	308419	311654R
Crankshaft - 6 bolt fixing, from engine no LF510E	311654	311654R
Piston assembly - to engine no LF20000E	155473F	155473
Piston assembly - to engine no LF20000E	155473G	155473
Piston Assembly - to engine no LF20000E, anti-pollution USA	157894F	
Piston Assembly - to engine no LF20000E, anti-pollution USA	157894G	
Piston Assembly - from engine no LF20001E, anti-pollution USA from engine	159792F	
Piston Assembly - from engine no LF20000E, anti-pollution USA from engine	159792G	
Piston assembly - from engine no LF20000E	160010F	
Piston Assembly - from engine no LF20000E	160010G	
Dowel	UKC1937	UKC1938

ENGINE

02-10 Crankshaft, Flywheel, Piston, Connecting Rod & Idler Shaft continued	Part No	
	Triumph	Rimmer Bros
Main bearing set		RTC1757
Main bearing set +0.010"		RTC1757.10
Main bearing set +0.020"		RTC1757.20
Main bearing set +0.030"		RTC1757.30
Main bearing set +0.040"		RTC1757.40
Main bearing set +0.060"		RTC1757.60
Thrust washer - oversize +0.005"		RTC2836.05
Thrust washer - oversize +0.010"		RTC2836.10