

ENGINE - Carburettor Details R.H. (anti-pollution only)

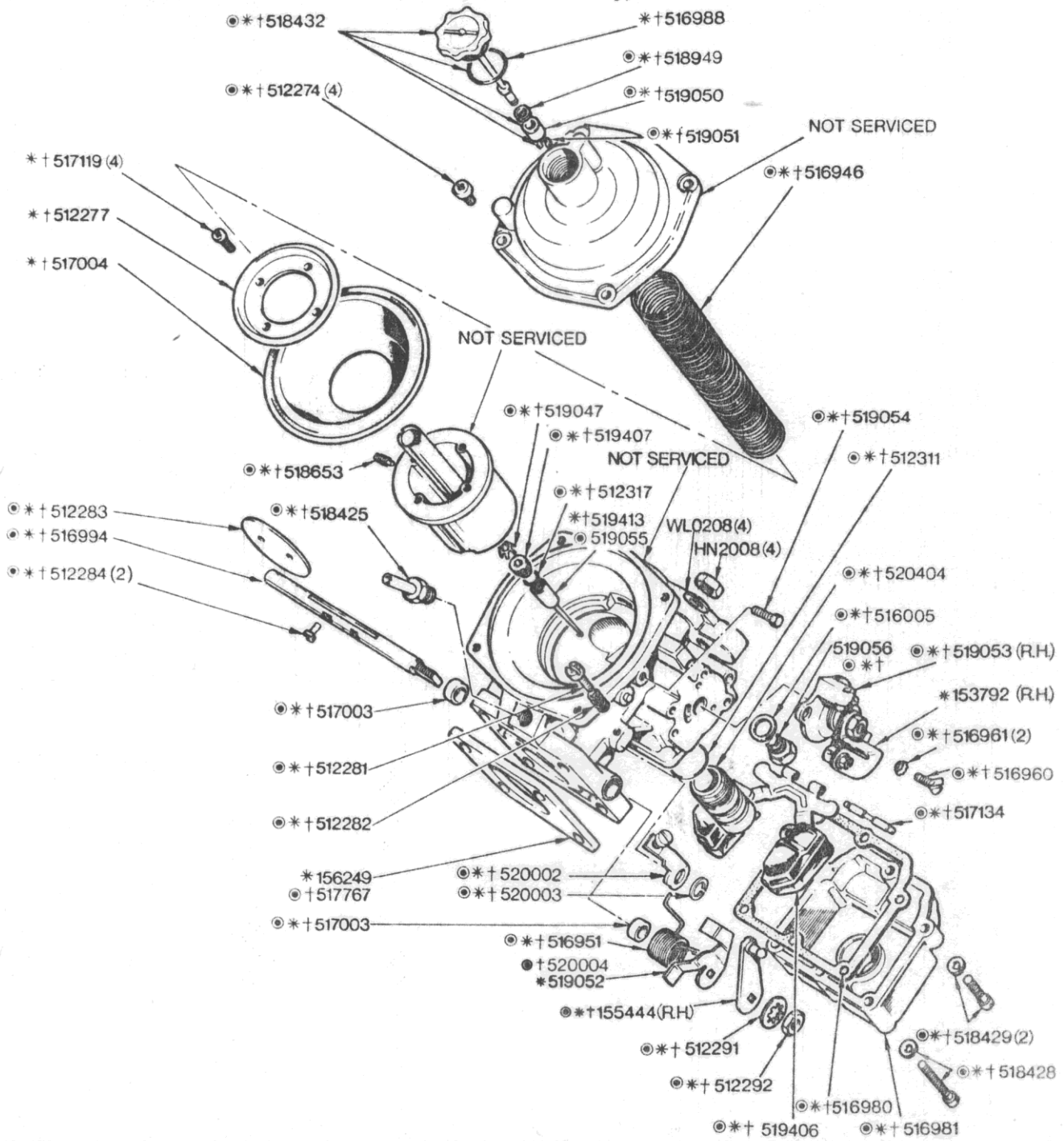

NOTE
 311218 Carburettor Assembly R.H. fitted up to Engine No LE 946E only.
 311965 Carburettor Assembly RH fitted from Engine No LE 947E up to 5000E
 312209 Carburettor Assembly RH fitted from Engine No LE 5001E
 For all other details see Plate 02-27

Comprising items marked thus *
 Comprising items marked thus †
 Comprising items marked thus ◎

ENGINE

| 02-25 Carburettor Details RH (anti-pollution engines only) | Part No | |
|---|---------|-------------|
| | Triumph | Rimmer Bros |
| Choke lever - to engine no LE946E | 153792 | |
| Throttle lever | 155444 | |
| Gasket - to engine no LE946E | 156249 | |
| Carburettor assembly - RH, to engine no LE946E | 311218 | |
| Carburettor assembly - RH, from engine no LE947E to LE5000E | 311965 | |
| Carburettor assembly - RH, from engine no LE5001E | 312209 | |
| Screw & spring washer | 512274 | 605847A |
| Retaining ring - to engine no LE5000E | 512277 | |
| Screw | 512281 | 512281 |
| Spring | 512282 | 512282 |
| Throttle | 512283 | 605800 |
| Screw | 512284 | 605801 |
| Washer - shakeproof | 512291 | GHF322 |
| Nut | 512292 | 512292 |
| O-Ring | 512311 | 512311 |
| O-ring | 512317 | 512317 |
| Washer | 516005 | |
| Spring | 516946 | 516946 |
| Spring | 516951 | 516951 |
| Screw | 516960 | 516960 |
| Washer - shakeproof | 516961 | 516961 |
| Gasket | 516980 | 12882A |
| Float chamber | 516981 | |
| Damper O-ring - to engine no LE5000E | 516988 | 516988 |
| Spindle | 516994 | 516994 |
| Seal | 517003 | |
| Diaphragm - to engine no LE5000E | 517004 | JS499A |
| Screw - to engine no LE5000E | 517119 | 517119 |
| Float pivot pin | 517134 | 606819A |
| Gasket - from engine no LE947E | 517767 | |
| Setscrew & washer - lock | 518428 | 605837 |
| Setscrew & washer - lock | 518429 | 605838 |
| Damper assembly | 518432 | 518432 |
| Retaining screw | 518653 | 518653 |
| Damper washer | 518949 | |
| Retaining washer | 519047 | |
| Damper bushing | 519050 | |
| Retaining ring | 519051 | |
| Throttle stop - to engine no LE946E | 519052 | |
| Starter assembly | 519053 | 519053 |
| Screw | 519054 | |
| Metering needle - from engine no LE5001E | 519055 | 519055 |
| Needle valve | 519056 | AAU4547 |
| Float & arm | 519406 | 605833A |
| Adjuster screw with O-ring | 519407 | |
| Main metering needle - to engine no LE5000E | 519413 | |
| Throttle stop - from engine no LE947E | 520004 | 520004 |
| Float chamber sealing plug | 520404 | 520404 |
| Nut | HN2008 | GHF201 |
| Washer - lock | WL0208 | GHF332 |