

GEARBOX-Top Cover Extension and Selectors.

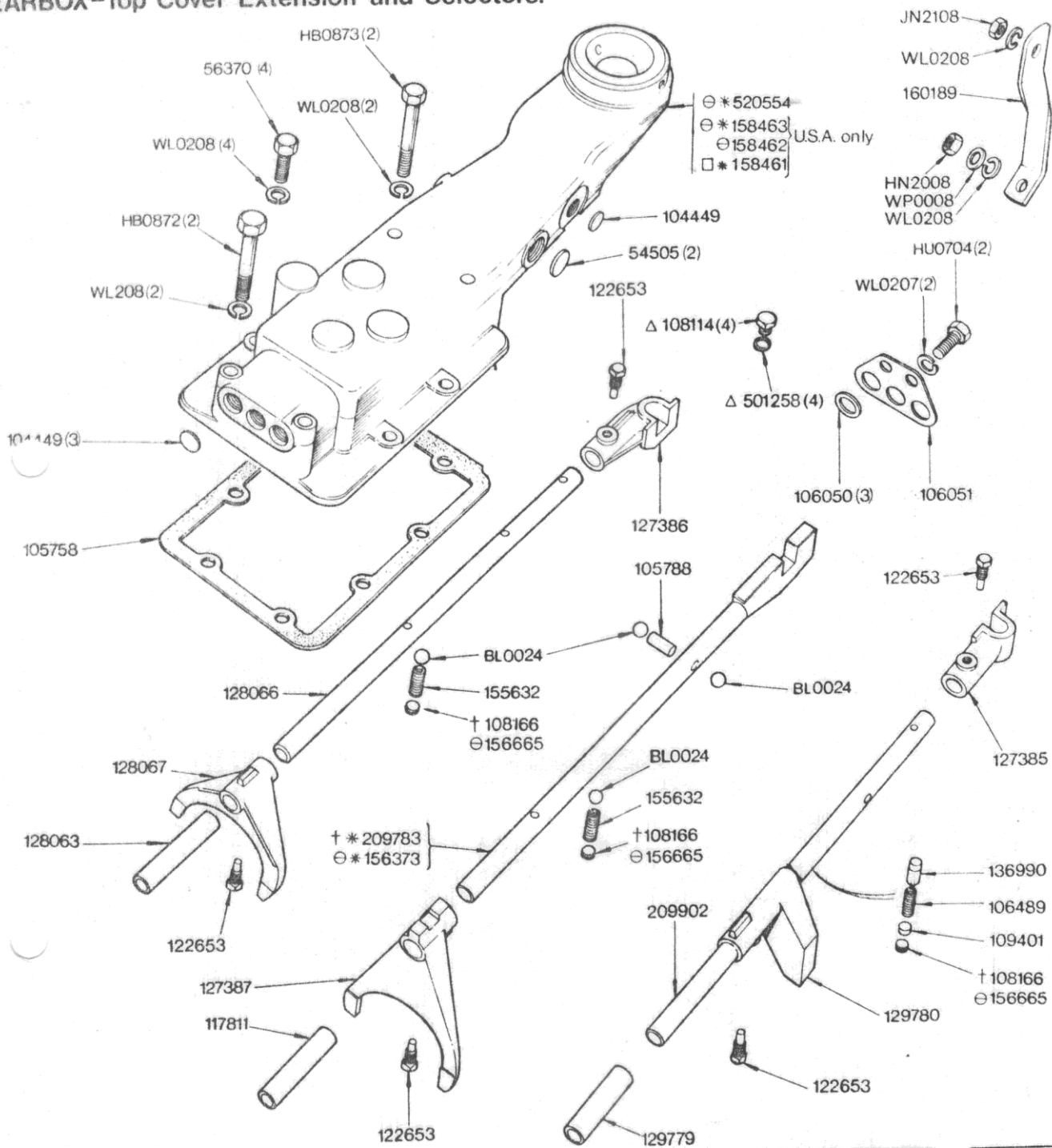

NOTE:
Items marked thus * are for overdrive only

- ⊖ * 520328 Top Cover Assembly 1off
- ⊖ 520548 Top Cover Assembly 1off
- ⊖ * 311862 Top Cover Assembly 1off
- TKC 1000 Top Cover Assembly 1off (use for all replacements)

- ⊖ Fitted from Commission No [blank] and Future
- ⊖ Fitted from Commission No LE 112774 up to [blank]
- ⊖ Fitted from Commission No LE 112774 and future
- Δ For use with Topcover 311862
- Fitted from Commission No [blank] and future
- Fitted from Commission No [blank] and future

GEARBOX

02-37 Top Cover Extension & Selectors	Part No	
	Triumph	Rimmer Bros
Core plug	54505	54505
Setscrew	56370	56370
Core plug	104449	104449
Gasket	105758	105758
Roller interlock	105788	105788
Sealing ring	106050	106050
Selector shaft cover plate	106051	106051
Spring	106489	22G2198
Blanking plug - for use with top cover 311862	108114	
Spring plug - to commission no ?	108166	
Distance piece	109401	109401
Sleeve - 3 rd /4 th shaft	117811	117811
Setscrew	122653	122653
Reverse gear selector	127385	127385
1 st /2 nd actuator	127386	127386
3 rd /4 th selector fork	127387	127387
Sleeve - 1 st /2 nd shaft	128063	128063
1 st /2 nd selector shaft	128066	128066
1 st /2 nd selector fork	128067	128067
Reverse selector sleeve	129779	129779
Reverse actuator	129780	129780
Reverse selector plunger	136990	136990
Spring	155632	155632
3rd/4th selector shaft - from commission no ?	156373	156373
Spring plug - from commission no ?	156665	156665
Top cover - USA only, overdrive, from commisssion ?	158461	
Top cover - USA only, from commisssion ?	158462	
Top cover - USA only, overdrive, from commisssion ?	158463	
Gearbox top cover steady strap	160189	160189
3rd/4th selector shaft - to commission no ?	209783	
Reverse selector shaft	209902	209902
Top cover assembly - overdrive from LD21230	311862	
Top cover assembly - USA overdrive to LE20857	311862	
Washer - copper, for use with top cover 311862	501258	
Top cover assembly - overdrive to LD21230	520328	
Top cover assembly	520548	
Top cover	520554	
Ball bearing	BL0024	BLS112
Bolt	HB0872	BH505201
Bolt	HB0873	
Nut	HN2008	GHF201
Setscrew	HU704	SH604041
Nut - jam	JN2108	GHF201
Top cover assembly - use for all replacements	TKC1000	TKC1000
Washer - lock	WL0207	GHF331
Washer - lock	WL0208	GHF332
Washer - plain	WP0008	GHF301