

PROPELLOR SHAFT AND ROAD WHEELS

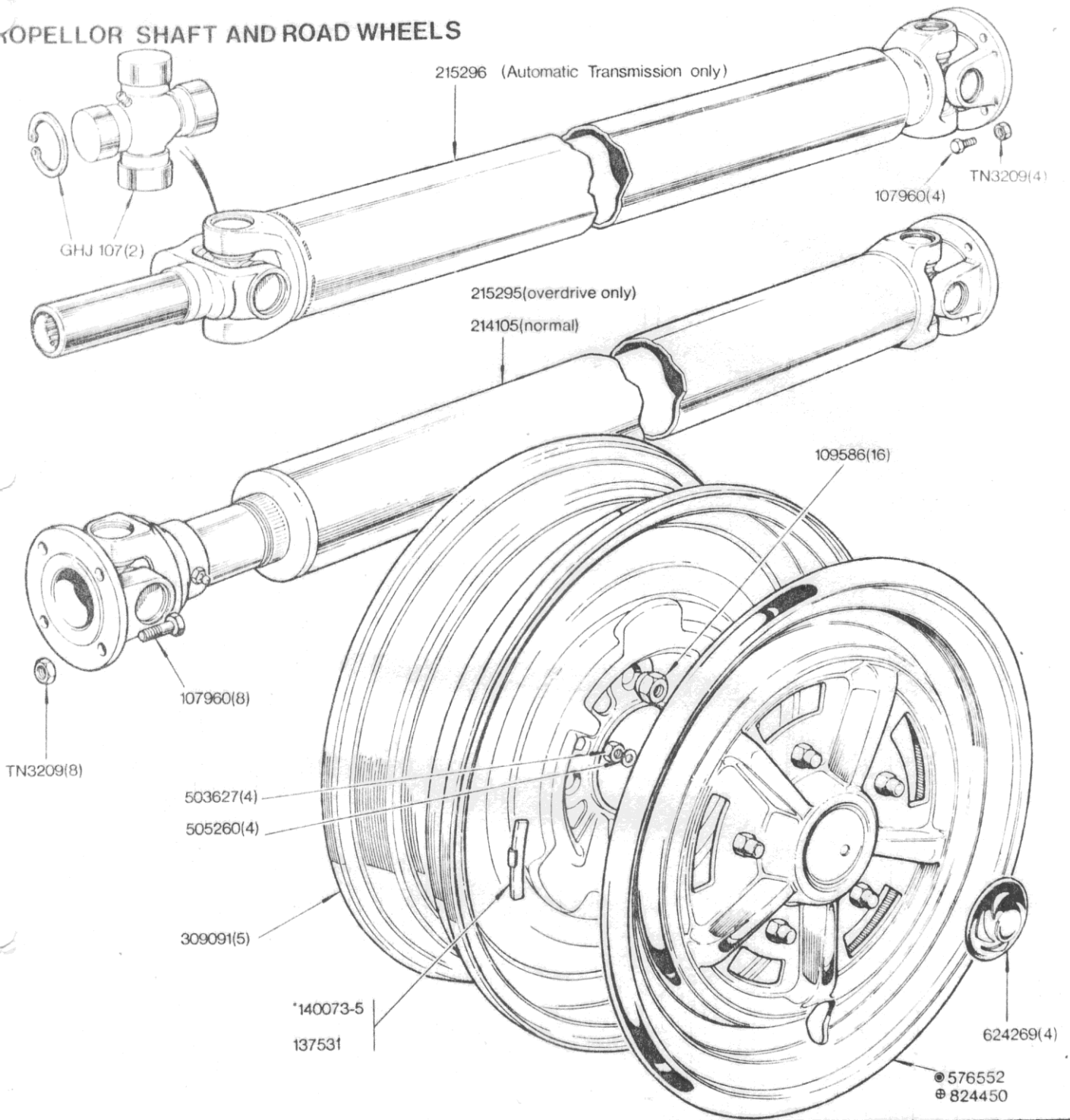

NOTE

140075	WEIGHT, BALANCE	2oz.	A/R
140074	WEIGHT, BALANCE	1½ oz.	A/R
140073	WEIGHT, BALANCE	1oz.	A/R
137531	WEIGHT, BALANCE	½ oz.	A/R

● Fitted up to Commission No. 20,000LD only.
 ⊕ Fitted from Commission No. 20,001LD and future

PROPELLOR SHAFT & ROAD WHEELS

02-49 Propellor Shaft & Road Wheels	Part No	
	Triumph	Rimmer Bros
Bolt	107960	107960
Wheel nut	109586	109586
Balance weight - ½oz	137531	
Balance weight - 1oz	140073	
Balance weight - 1½oz	140074	
Balance weight - 2oz	140075	
Propellor shaft assembly - non-overdrive	214105	
Propellor shaft assembly - overdrive	215295	215295
Propellor shaft assembly - automatic transmission only	215296	215296
Road wheel	309091	309091
Nut	503627	UCN1162
Washer	505260	WL205
Wheel trim - black centre, to commission no LD20000	576552	576552
Wheel centre badge	624269	624269
Wheel trim - unpainted centre, from commission no LD20000	824450	824616
Universal joint & circlip	GHJ 107	GUJ102
Nut - nyloc	TN3209	TN3209
Nut - nyloc	TN3209	TN3209