

# CLUTCH MASTER CYLINDER

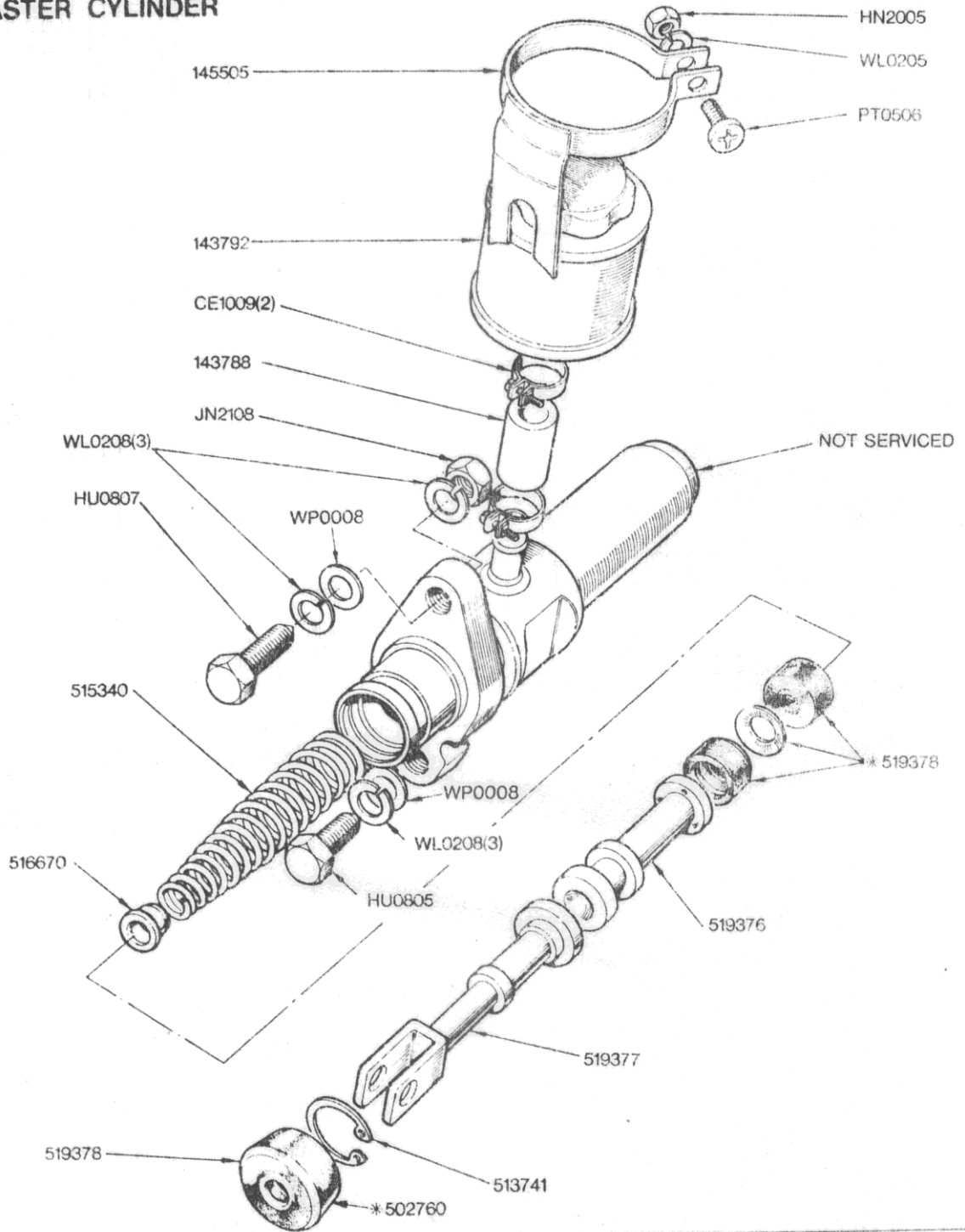

NOTE  
 153260 CLUTCH MASTER CYLINDER  
 (Not required for Borg Warner transmission)  
 \* 519378 Service Kit

# CLUTCH

02-62 Master Cylinder	Part No	
	Triumph	Rimmer Bros
Hose	143788	143788
Reservoir	143792	143792
Assembly support bracket	145505	RS1557
Clutch master cylinder assembly	153260	AEU1644
Boot	502760	
Retainer	513741	
Spring	515340	
Spring retainer	516670	
Clutch master cylinder piston	519376	
Clutch master cylinder push rod assembly	519377	
Clutch master cylinder service kit	519378	
Clip	CE1009	CS4009
Nut	HN2005	HN2005
Setscrew	HU0805	SH605071
Setscrew	HU0807	SH605071
Nut - jam	JN2108	GHF201
Screw	PT0506	PX506
Washer - lock	WL0205	WL205
Washer - lock	WL0208	GHF332
Washer - plain	WP0008	GHF301
Filler cap		513123A
Clutch master cylinder repair kit - early type		519398
Clutch master cylinder repair kit - late type (suits AEU1644)		BAU1252
Clevis pin		PJ8808
Washer - plain		GHF301
Cotter pin		PC10