

ELECTRICAL EQUIPMENT - Starter Motor

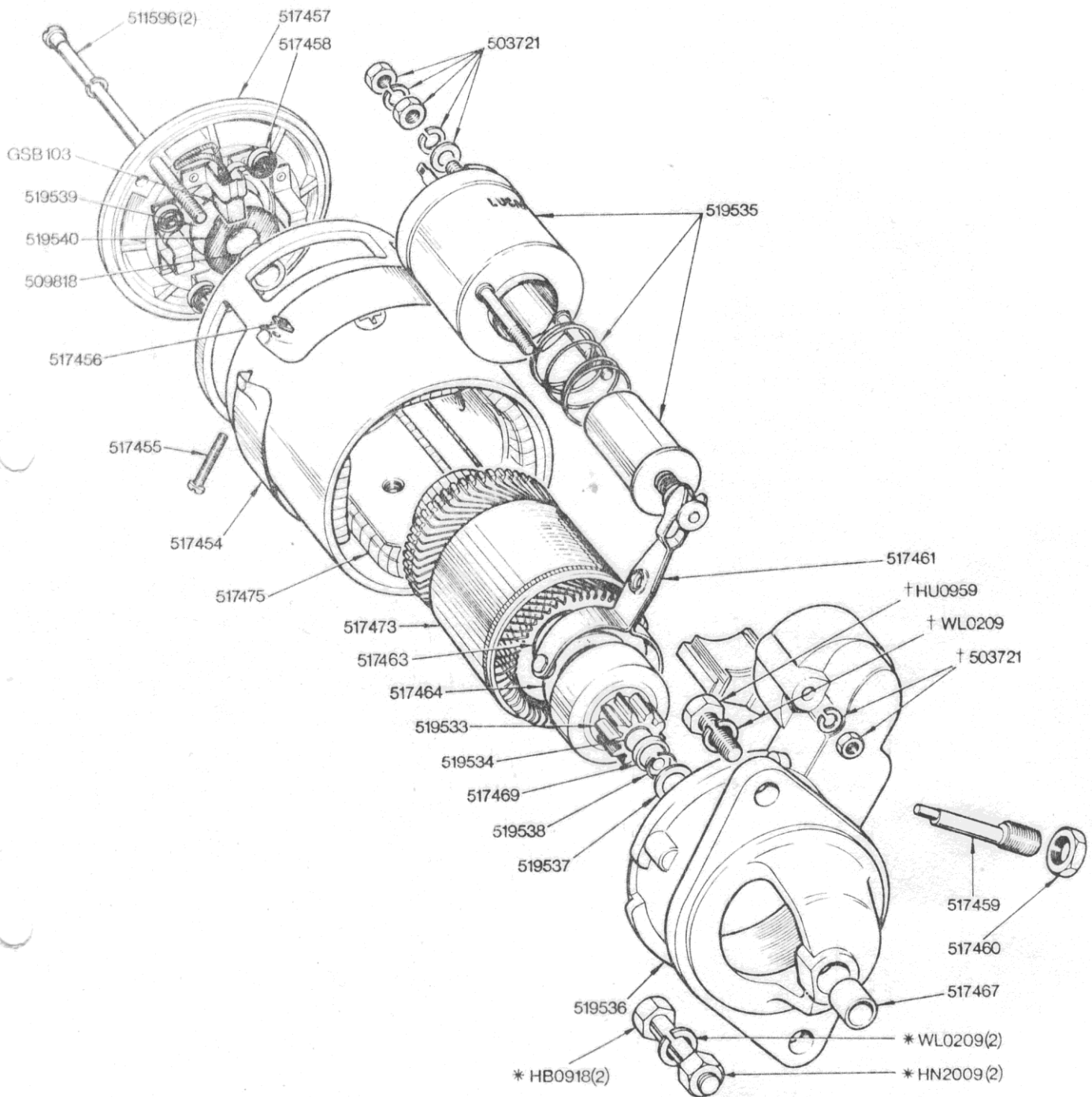

215112 STARTER MOTOR ASSEMBLY

NOTE: Items marked thus * are only required when Automatic Transmission is fitted
 Items marked thus † are not required when Automatic Transmission is fitted

ELECTRICAL EQUIPMENT

03-08 Starter Motor	Part No		
	Triumph	Lucas	Rimmer Bros
Starter motor	215111	25627E	
Sundry parts kit	503721	271731	
Bush - commutator end	509818	251477	
Bolt, through fixing	511596	256009	
Cover band	517454	54240319	
Cover band fixing screw	517455	127584	
Cover band fixing nut	517456	169160	
Bracket - commutator end	517457	54240300	
Brush tension spring set	517458	54257221	
Pivot bolt	517459	54240485	
Nut for pivot bolt	517460	272549	
Pinion engaging lever	517461	54240960	
Drive ring, bush retaining	517463	291013	
Drive plate, lever operating	517464	54259624	
Bush - drive end	517467	54252054	
Thrust collar - drive end	517469	54252863	
Armature	517473	54240322	
Field coil set	517475	54240313	
Drive	519533	54242102	
Bush	519534	54252075	
Solenoid - suitable for 215111	519535	76826	AEU1649
Bracket - drive end	519536	54243000	
Thrust washer - drive end	519537	54250549	
Jump ring - drive end	519538	54250703	
Thrust washer - commutator end	519539	54140202	
Fabric thrust washer - commutator end	519540	54140203	
Solenoid - suitable for 215111/2	520473	76878	520473
Starter motor	215111/2	25648E	215111-2
Brush set	GSB103	255659	GSB103
Bolt - hexagon head, only required automatic transmission is fitted	HB0918		BH606181
Nut - steel, only required automatic transmission is fitted	HN2009		GHF202
Setscrew - hex head, only required manual transmission is fitted	HU0959		SH506101
Washer - lock, only required manual transmission is fitted	WL0209		GHF333
Washer - lock, only required automatic transmission is fitted	WL0209		GHF333
Starter motor - high torque			2151112-UR
Solenoid cap only			520473CAP