

CENTRAL EQUIPMENT—Facia Instruments and Switches

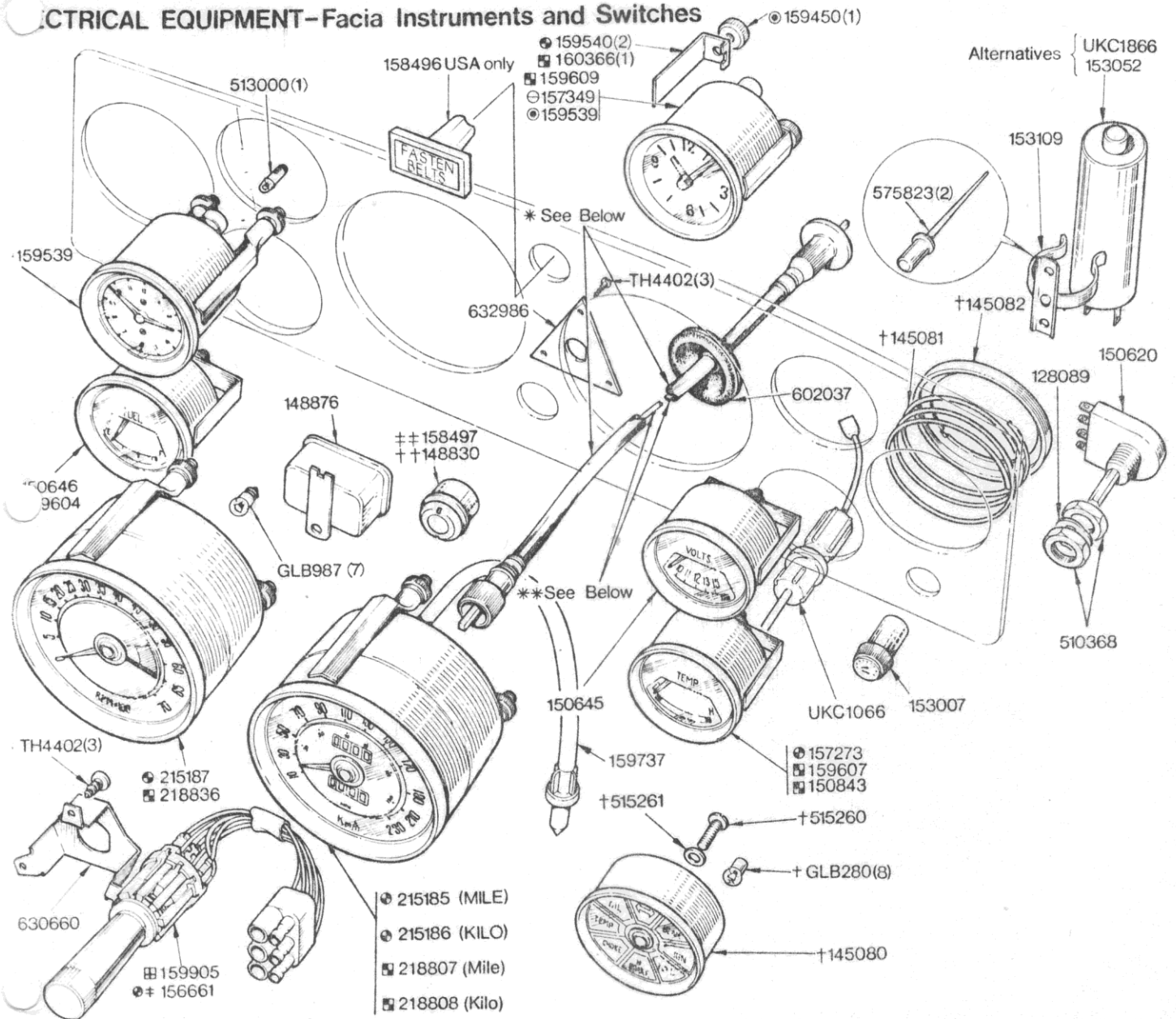

- ⊕ 215185 (MILE)
- ⊕ 215186 (KILO)
- ⊕ 218807 (Mile)
- ⊕ 218808 (Kilo)

NOTE

- * GSD140 Speedometer Cable Assembly outer for use with manual & overdrive gearbox 159539 and 159540 to be used for all replacements
- 154136/0 Speedometer Cable Assembly outer R.H.S. 60" long } for use with Borg Warner ±U.S.A only
- 154137/0 Speedometer Cable Assembly outer L.H.S. 42" long }
- 217288/0 Speedometer Cable Assembly outer R.H.S. } for use with overdrive gearbox 50" long may be used for all replacements
- 217286/0 Speedometer Cable Assembly outer L.H.S. }
- * 137707/1 Speedometer Cable Assembly inner for use with manual & overdrive gearbox
- 154136/1 Speedometer Cable Assembly inner R.H.S. 60" long } for use with Borg Warner
- 154137/1 Speedometer Cable Assembly inner L.H.S. 42" long }
- 217288/1 Speedometer Cable Assembly inner R.H.S. } for use with overdrive gearbox 50" long may be used for all replacements
- 217286/1 Speedometer Cable Assembly inner L.H.S. }
- 214992 Warning Light Cluster comprising all items marked thus † Fitted up to Commission No.T20,000LD only
- 216269 Warning Light Cluster comprising all items marked thus † Fitted from Commission No.T20,001LD and future and all cars for U.S.A.
- 219052 Warning Light Cluster comprising all items marked thus † Fitted from Commission No.T20,001LD and future

- ⊕ Time Clock Fitted up to Commission No. only
- ⊕ Time Clock Fitted from Commission No. and up to

- ⊕ Fitted from Commission No.T20,001LD and future
- UKC1066 Terminal Female 1 off } for use with 159607 for
- UKC1025 Resistor Ballast 1 off } first 500 car sets

ELECTRICAL EQUIPMENT

03-19 Facia Instruments & Switches	Part No		
	Triumph	Lucas	Rimmer Bros
Washer	128089		
Warning light cluster body assembly	145080		
Spring coil	145081		
Clip	145082		
Warning Light - hazard	148830		148830
Voltage stabiliser	148876		148876A
Panel light switch	150620	39258B	TKC3936
Fuel gauge - to commission no T20000LD	150646		150646
Temperature transmission - from commission no T20001LD	150843		
Panel light switch knob	153007	54328269	153007
Inertia cut-out switch - alt	153052		C41220A
Inertia cut-out switch mounting bracket	153109		153109
Hazard switch warning - USA only, to commission no T20000LD	156661		
Temperature gauge - to commission no T20000LD	157273		157273
Seat belt warning light - USA only	158496		13H7986
Warning Light - brake	158497		158497
Nut	159450		
Time clock - to commission no T20000LD	159539		159539
Clamp clock - to commission T20000LD	159540		
Fuel gauge - from commission no T20001LD	159604		159604
Temperature gauge - from commission no T20001LD	159607		159607
Time clock - from commission no T20001LD	159609		159609
Speedometer trip reset	159737		159737
Hazard switch warning - USA only, from commission no T20001LD	159905		159905A
Clamp clock - from commission T20001LD	160366		
Warning light cluster - to commission no T20000LD	214992		
Speedometer - MPH, to commission no T20000LD	215185		215185
Speedometer - KPH, to commission no T20000LD	215186		215186
Revolution counter - to commission no T20000LD	215187		215187
Warning light cluster - from commission no T20000LD & all USA cars	216269		
Speedometer - MPH, from commission no T20001LD	218807		218807
Speedometer - KPH, from commission no T20001LD	218808		218808
Revolution counter - from commission no LD20001	218836		218836
Warning light cluster - from commission no T20000LD	219052		
Nut	510368		510368
Bulb	513000		GLB281
Screw	515260		
Rivet	575823		713531
Grommet	602037		
Bracket hazard switch - USA only	630660		
Bracket H/Switch - USA	632986		
Speedometer cable assembly inner for use with manual & overdrive gearbox	137707/1		
Speedometer cable assembly outer RHS 60" long for use with Borg Warner gearbox	154136/0		
Speedometer cable assembly inner RHS 60" long for use with Borg Warner gearbox	154136/1		
Speedometer cable assembly outer LHS 42" long for use with Borg Warner gearbox	154137/0		
Speedometer cable assembly inner LHS 42" long for use with Borg Warner gearbox	154137/1		
Speedometer cable assembly outer LHS for use with overdrive gearbox 50" long	217286/0		
Speedometer cable assembly inner LHS for use with overdrive gearbox 50" long	217286/1		

ELECTRICAL EQUIPMENT

03-19 Facia Instruments & Switches continued	Part No		
	Triumph	Lucas	Rimmer Bros
Speedometer cable assembly outer RHS for use with overdrive gearbox 50" long	217288/0		
Speedometer cable assembly inner RHS for use with overdrive gearbox 50" long	217288/1		
Bulb	GLB280		GLB280
Bulb	GLB987		GLB987
Speedometer cable assembly outer for use with manual & overdrive gearbox	GSD140		
Woodscrew	TH4402		
Woodscrew - USA only	TH4402		
Gauge temperature with resistor	UKC1066		
Inertia cut-out switch - alt	UKC1866		C41220A
Speedometer cable - RHS, manual, non-overdrive			217288
Speedometer cable - LHS, manual, non-overdrive			217286
Speedometer cable - RHS, manual, A-type overdrive			217288
Speedometer cable - LHS, manual, A-type overdrive			217286
Speedometer cable - RHS, manual, J-type overdrive			219167
Speedometer cable - LHS, manual, J-type overdrive			219168
Speedometer cable - RHS, automatic, type 35 & 65			GSD311
Speedometer cable - LHS, automatic, type 35 & 66			GSD289
Warning light cluster - to commission no T20000LD			216269
Warning light cluster - from commission no T20001LD to T35940LD			219052
Warning light cluster - from commission no T35941LD			TKC3181