

# BODY AND FITTINGS - Heater Details

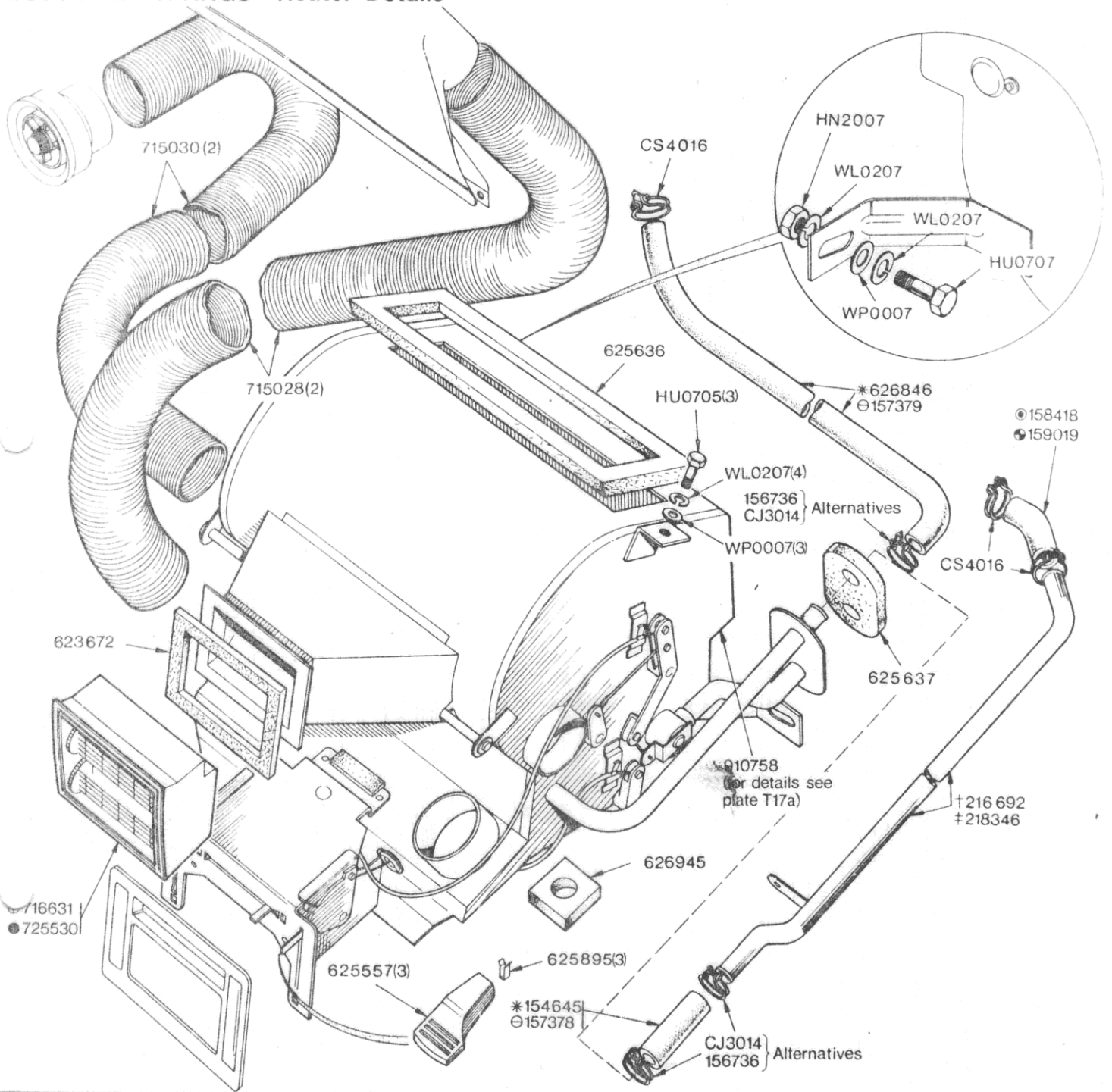

**NOTE**

† Fitted up to Commission No	only
‡ Fitted from Commission No	and future
⊙ Fitted up to Commission No LF10316 only	
⊛ Fitted from Commission No LF10317 and future	
* Fitted up to Commission No	only
⊕ Fitted from Commission No	and future
⊕ Fitted up to Commission No	only
⊙ Fitted from Commission No	and future

## BODY & FITTINGS

03-47 Heater Details	Part No	
	Triumph	Rimmer Bros
Hose heater outlet - to commission no ?	154645	
Clip hose - alternative	156736	
Hose heater outlet - from commission no ?	157378	157378
Hose heater inlet - from commission no ?	157379	157379
Hose bypass to water pump cvr & heater return - to commission no LF10316	158418	GZA1013
Hose bypass to water pump cvr & heater return - from commission no LF10317	159019	159019
Pipe assembly water return heater to pump - to commission no ?	216692	
Pipe assembly water return heater to pump - from commission no ?	218346	218346
Seal col air outlet	623672	
Knob heater control	625557	625557
Seal heater to dash	625636	
Clip knob attachment	625895	625895A
Hose heater inlet - to commission no ?	626846	
Seal drain tube	626945	
Demister hose	715028	715028
Heater hose to louvre ventilator	715030	715030
Ventilator centre panel facia - to commission no ?	716631	
Ventilator centre panel facia - from commission no ?	725530	
Heater unit	910758	910758
Pipe clip - Jubilee - alternative	CJ3014	
Pipe clip - Supergrip	CS4016	GHC406
Nut - steel	HN2007	
Setscrew - hex head	HU0705	
Setscrew - hex head	HU0707	
Washer - lock, light & medium	WL0207	
Washer - plain, light	WP0007	