

**OVERDRIVE - Maincasing, Piston and Filter (Fitted up to Commission No. LD21230 and LE20856 only)**

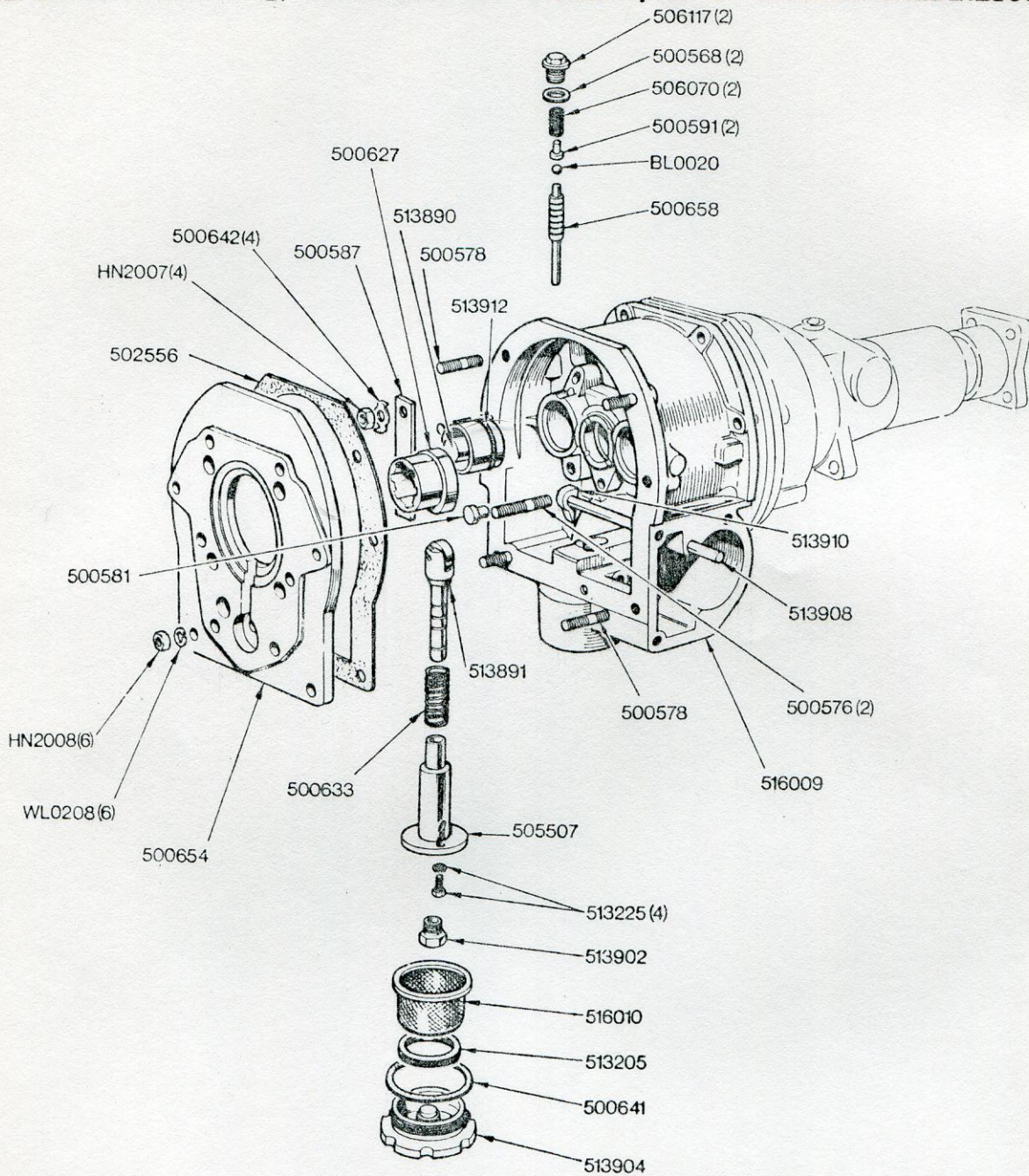

**NOTE**

308713	OVERDRIVE UNIT ASSEMBLY	1 off
	(fitted up to comm. no. LD110 only, excluding LD209, LD217 and LD218)	
311772	OVERDRIVE UNIT	1 off
	Fitted on comm. no. LD209, LD217, LD218 and from LD221 up to	
513909	LEVER, valve setting.	1 off
500594	O'RING, valve operating shaft	2 off
513888	DOWEL, spring, securing setting and cam lever	2 off
518106	BEARING KIT, planet wheels	6 off

# OVERDRIVE

04-10 Maincasing, piston & filter Fitted up to Commission no LD21230 and LE20856 only	Part No	
	Triumph	Rimmer Bros
Overdrive unit assembly (to commission no LD110, excluding LD209, LD217 & LD218)	308713	
Overdrive unit assembly (to commission nos LD209, LD217 & LD218 and from LD221 to ?)	311772	311772
Lever, valve setting	513909	
O-ring, valve operating shaft	500594	500594
Dowel, spring, securing setting & cam lever	513888	
Bearing kit, planet wheels	518106	
Adaptor plate	500654	208098
Gasket	502556	502556
Nut - steel	HN2008	GHF201
Washer, lock	WL0208	GHF332
Nut - steel	HN2007	GHF200
Washer, tab	500642	JS616A
Bridge piece	500587	500587
Piston operating assembly	513890	513890
Stud	500578	FHS2510
O-ring	513912	513912
Guide	500581	268112
Stud	500576	500576
Stud	500578	FHS2510
Shaft	513908	
Casing	516009	
Plunger assembly	513891	513891
Spring	500633	500633
Oil pump body	505507	505507
Setscrew	513225	PX505
Plug	513902	513902
Oil filter	516010	516010
Magnet set	513205	513205
Washer, fibre	500641	500641
Sump oil drain plug	513904	521814
Plug	506117	268095
Washer	500568	3H693
Spring	506070	506070
Plunger	500591	500591
Ball, steel	BL0020	
Operating valve	500658	500658