

OVERDRIVE UNIT- Rear Case, Speedo Gears, Flange.

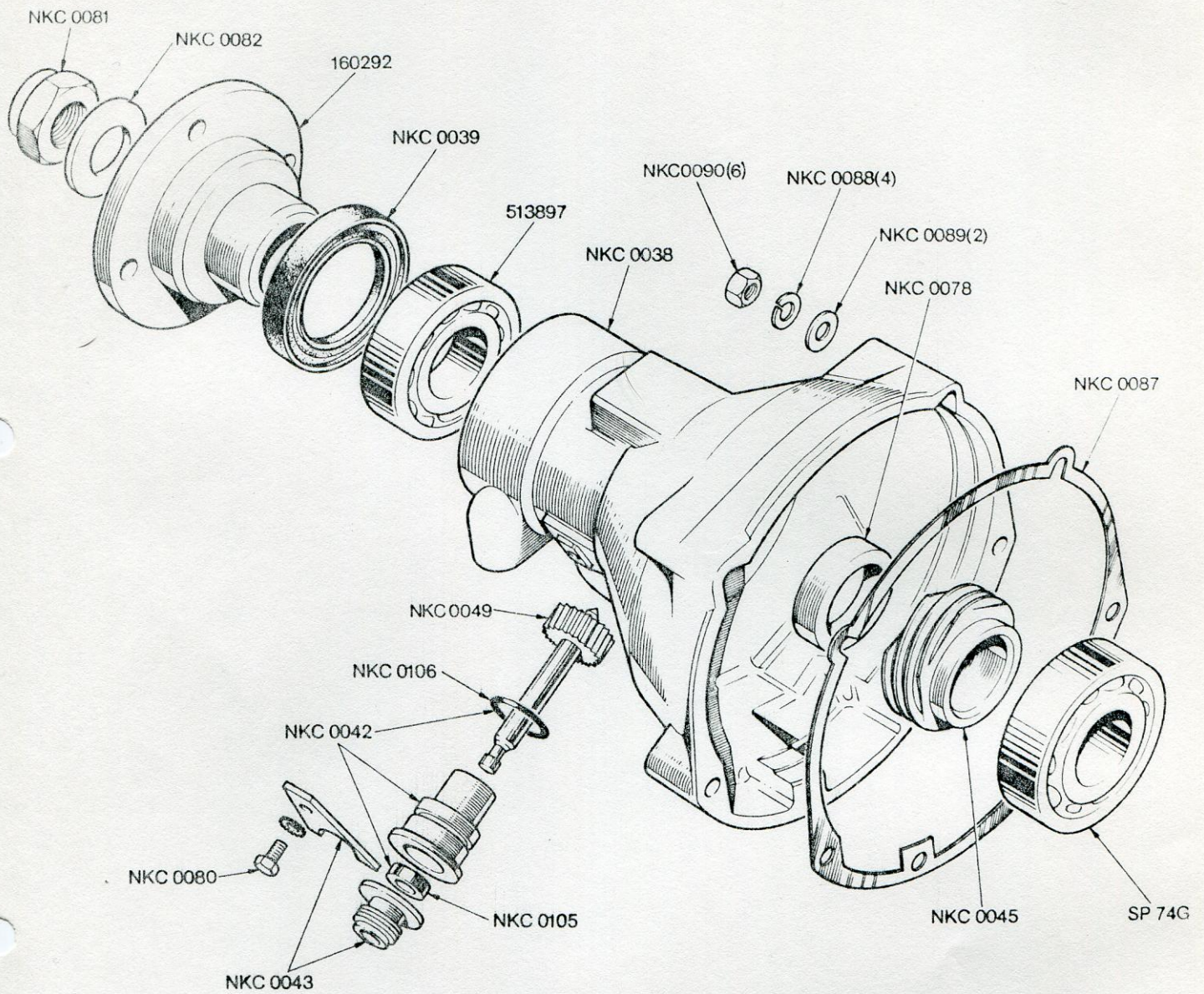

OVERDRIVE

04-15 Rear case, speedo gears, flange	Part No	
	Triumph	Rimmer Bros
Nut, coupling flange	NKC0081	NKC81
Circlip	NKC0082	NKC82A
Output/Drive Flange	160292	160292
Oil seal, rear case	NKC0039	NKC39
Bearing assembly	513897	513897
Rear case	NKC0038	NKC38
Nut	NKC0090	NKC90
Washer, spring	NKC0088	NKC88
Washer, plain	NKC0089	NKC89
Output shaft spacer	NKC0078	NKC78
Speedo driving gear	NKC0045	NKC45
Bearing Assembly	SP74G	SP74G
Gasket	NKC0087	NKC87
Bolt	NKC0080	NKC80
Speedo connector	NKC0043	NKC43
Oil seal	NKC0105	NKC105
Speedo bearing kit	NKC0042	NKC42
Washer, copper, solenoid valve	NKC0108	NKC108
Speedo Drive Pinion - 18 Teeth	NKC0049	NKC49