

AUTOMATIC TRANSMISSION-Inhibitor Switch and Parking Details

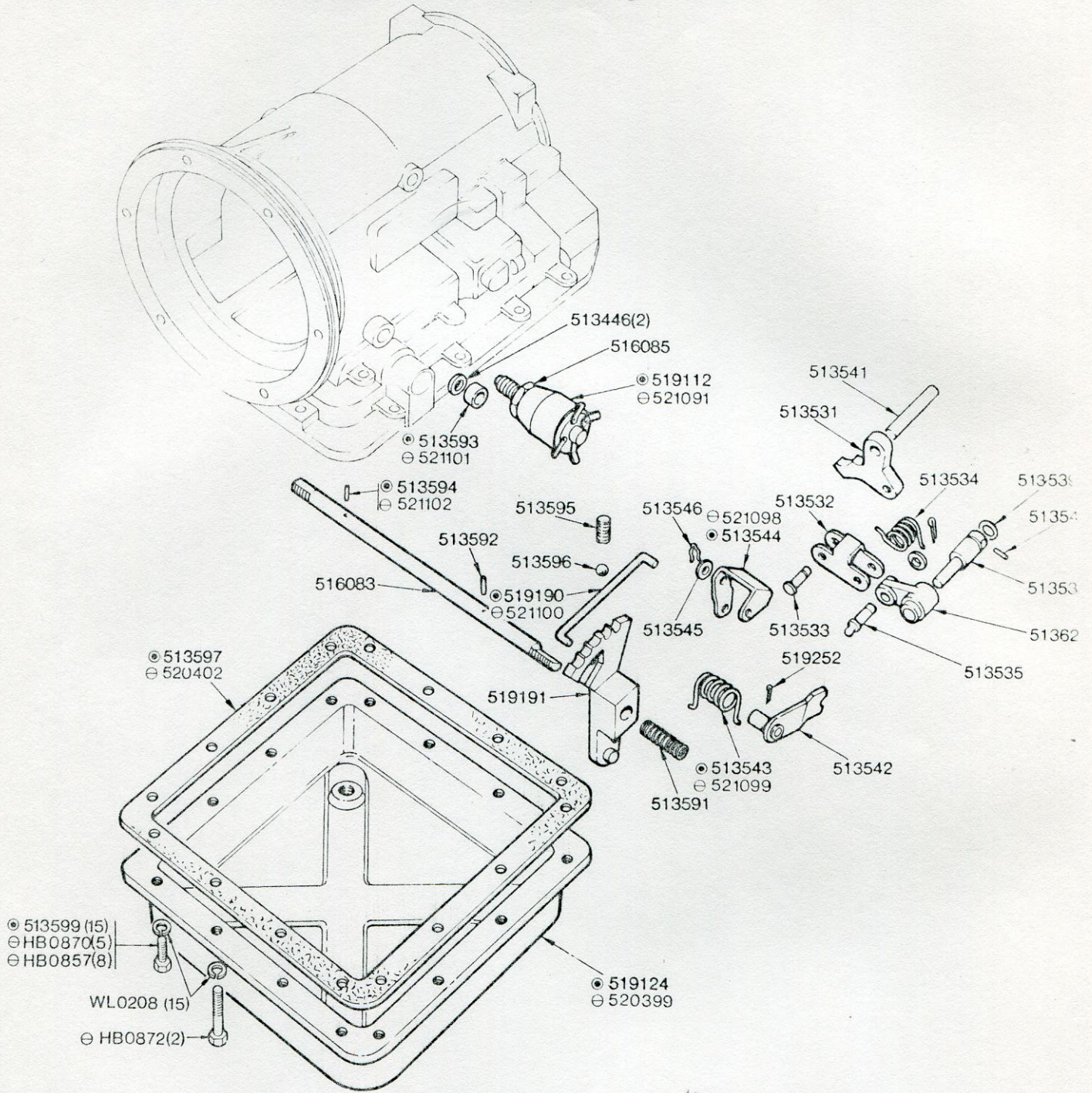

NOTE

- Fitted up to Commission No. LF2731 only
- ⊖ Fitted from Commission No. FF2732 and future

AUTOMATIC TRANSMISSION (BORG WARNER TYPE 35)

04-19 - Inhibitor switch and parking details	Part No	
	Triumph	Rimmer Bros
Oil pan assembly - to Commission No LF2731	519124	519124
Oil pan assembly - from Commission No LF2732	520399	520399
Bolt - to Commission No LF2731	513599	
Bolt, hexagon head - from Commission No LF2732	HB0870	HB870
Bolt, hexagon head - from Commission No LF2732	HB0857	HB857
Washer, lock	WL0208	GHF332
Bolt, hexagon head - from Commission No LF2732	HB0872	BH505201
Washer, lock	WL0208	GHF332
Gasket, oil pan - to Commission No LF2731	513597	
Gasket, oil pan - from Commission No LF2732	520402	520402
Shaft	516083	516083
Cotter pin - to Commission No LF2731	513594	
Cotter pin - from Commission No LF2732	521102	
Pin	513592	
Parking brake link - to Commission No LF2731	519190	
Parking brake link - from Commission No LF2732	521100	
Ball	513596	
Spring	513595	
Manual valve lever	519191	
Spring	513591	
Spring - to Commission No LF2731	513543	
Spring - from Commission No LF2732	521099	
Lever	513542	
Torsion lever pin	519252	
Parking pawl tension spring - to Commission No LF2731	513543	
Parking pawl tension spring - from Commission No LF2732	521099	
Spring	513546	
Washer	513545	
Parking brake torsion lever - to Commission No LF2731	521098	
Parking brake torsion lever - from Commission No LF2732	513544	
Pin	513533	601087
Link	513532	601086
Pin	513535	
Lever	513626	
Pawl	513531	601085
Pin	513541	
Spring	513534	
Pin	513538	
Pin	513540	
Ring	513539	
Inhibitor switch - to Commission No LF2731	519112	
Inhibitor switch - from Commission No LF2732	521091	
Inhibitor switch		RTC1150
Locknut	516085	
Washer, manual valve - to Commission No LF2731	513593	
Washer, manual valve - from Commission No LF2732	521101	
Seal	513446	